

永磁直行星齿轮电机 (内齿圈材质: 金属)

PM DC Planetary Gear Motor (Ring Gear Material: Metal)

56JX200K/60ZY95 $\Phi 56$ 标准型减速器, 允许转矩范围: 2N.m~20N.m
 56mm OD Standard Gearbox, Permissible Load Range: 2N.m~20N.m

● 外形和安装尺寸 Dimensions

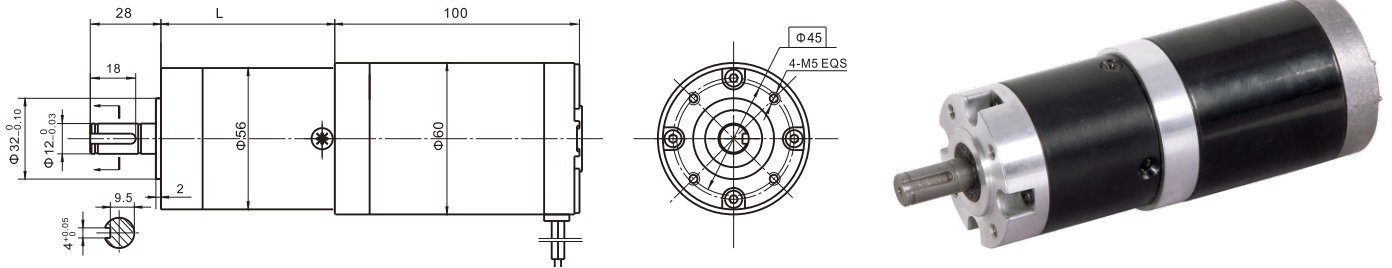

● 电动机主要技术参数 Motor Technical Data

电机型号 TYPE	额定电压 Rated voltage VDC	空载转速 No-load speed r/min	空载电流 No-load current A	额定转速 Rated speed r/min	额定转矩 Rated torque mN.m	输出功率 Output power W	额定电流 Rated current A	堵转转矩 Stall torque mN.m	堵转电流 Stall current A
60ZY95-2420	24	2000	0.4	1600	150	25	1.8	560	6.0
60ZY95-2430	24	3000	0.5	2400	180	40	3.0	690	11.0

● 齿轮减速电机主要技术参数 Gear Motor Technical Data

配置60ZY95-2420直流电机 (60ZY95-2420 DC Motor)

减速比 Reduction ratio	3.6	4.25	7.5	13	15	18	27	32	47	55	65	76	115	168	198	234
减速级数 Number of gear trains	1	1	1	2	2	2	2	2	3	3	3	3	3	4	4	4
减速器长度(L) Length(L) mm	41	41	41	53	53	53	61	61	64	64	64	64	64	76	76	76
空载转速 No-load speed r/min	556	470	266	154	133	111	74	63	43	36	31	26	17	12	10	9
额定转速 Rated speed r/min	444	376	213	123	106	88	59	50	34	29	24	21	14	9.5	8	6.8
额定转矩 Rated torque N.m	0.48	0.57	1.0	1.5	1.8	2.1	3.2	3.8	5.1	6.0	7.1	8.3	12.5	16.5	19.6	20
最大瞬间允许负载 Max. permissible load in a short time N.m	6	6	6	25	25	25	25	25	50	50	50	50	50	60	60	60

配置60ZY95-2430直流电机 (60ZY95-2430 DC Motor)

减速比 Reduction ratio	3.6	4.25	7.5	13	15	18	27	32	47	55	65	76	115	168	198
减速级数 Number of gear trains	1	1	1	2	2	2	2	2	3	3	3	3	3	4	4
减速器长度(L) Length(L) mm	41	41	41	53	53	53	53	53	64	64	64	64	64	76	76
空载转速 No-load speed r/min	833	706	400	230	200	167	111	94	64	54	46	39	26	18	15
额定转速 Rated speed r/min	667	565	320	185	160	133	89	75	51	44	37	32	20	14	12
额定转矩 Rated torque N.m	0.58	0.68	0.82	1.9	2.1	2.6	3.9	4.6	6.1	7.2	8.5	10	15	19	20
最大瞬间允许负载 Max. permissible load in a short time N.m	6	6	6	25	25	25	25	25	50	50	50	50	50	60	60

● 电动机特性图 Motor Characteristic Figure

