

80JB100K/71ZY110

允许转矩范围: 10N.m
Permissible Load Range: 10N.m

● 产品特点和用途 Description of The Product

□80mm的一体式齿轮减速器，允许负载10.0N.m。合金结构钢齿轮，全部滚动轴承的配置。

□80mm integrated gearbox, with rated torque up to 10.0 N.m, alloy constructional steel gears, all equipped with ball bearings.

● 外形和安装尺寸 Dimensions

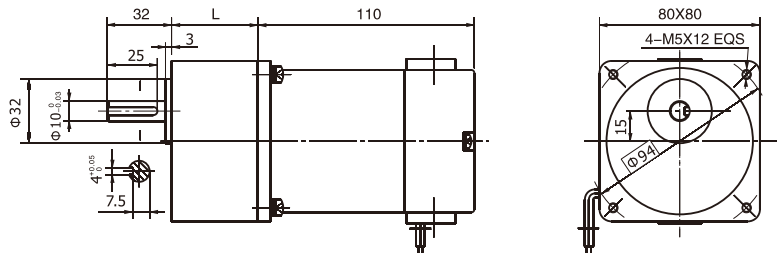

● 电动机主要技术参数 Motor Technical Data

电机型号 Type	额定电压 Rated voltage VDC	空载转速 No-load speed r/min	空载电流 No-load current A	额定转速 Rated speed r/min	额定转矩 Rated torque N.m	输出功率 Output power W	额定电流 Rated current A	堵转转矩 Stall torque N.m	堵转电流 Stall current A
71ZY110-2420	24	2000	0.4	1600	0.20	33	2.4	1.0	9.5
71ZY110-2430	24	3000	0.5	2400	0.24	59	3.5	1.2	14

● 齿轮减速电机主要技术参数 Gear Motor Technical Data

配置71ZY110-2420直流电机 (71ZY110-2420 DC Motor)

减速比 Reduction ratio	3	5	7.5	10	12.5	15	25	30	50	75
减速级数 Number of gear trains	2	2	2	2	2	2	3	3	3	4
减速器长度(L) Length(L) mm	32	32	32	32	32	32	43	43	43	43
空载转速 No-load speed r/min	667	400	267	200	160	133	80	67	40	27
额定转速 Rated speed r/min	533	320	213	160	128	106	64	53	32	21
额定转矩 Rated torque N.m	0.49	0.8	1.2	1.6	2.0	2.4	3.6	4.4	7.3	9.8
最大瞬间允许负载 Max. permissible load in a short time N.m	5.0	5.0	5.0	5.0	5.0	5.0	15	15	15	20
转向 Direction of rotation	CW	CW	CW	CW	CW	CW	CW	CCW	CCW	CW

配置71ZY110-2430直流电机 (71ZY110-2430 DC Motor)

减速比 Reduction ratio	3	5	7.5	10	12.5	15	25	30	50	75
减速级数 Number of gear trains	2	2	2	2	2	2	3	3	3	4
减速器长度(L) Length(L) mm	32	32	32	32	32	32	43	43	43	43
空载转速 No-load speed r/min	1000	600	400	300	240	200	120	100	60	40
额定转速 Rated speed r/min	800	480	320	240	192	160	96	80	48	34
额定转矩 Rated torque N.m	0.58	1.7	1.4	1.9	2.4	2.9	4.4	5.2	8.7	10
最大瞬间允许负载 Max. permissible load in a short time N.m	5.0	5.0	5.0	5.0	5.0	5.0	15	15	15	20
转向 Direction of rotation	CW	CW	CW	CW	CW	CW	CCW	CCW	CCW	CW

● 电动机特性图 Motor Characteristic Figure

